



ECON® Bourdon tube pressure gauge Type: 1334 Back mount Brass Direct

Characteristics

Type: 1334
Model: Bourdon tube pressure gauge
Blow-out included: No
Liquid-damped: No
Fill fluid: None
Pressure gauge attachment: Direct
Connection location: Back mount
Process connection: External thread
Process connection material: Brass
Protection class: IP54
Medium temperature: 0 / 60 °C
Ambient temperature: -20 / 60 °C

Application

- Light industry.
- Pneumatics.
- Installation technology.
- Recommended in: Utilities

Technical Information

- Suitable for gases and liquids that do not affect the brass measuring system.
- Measuring ranges according to EN 837-1.

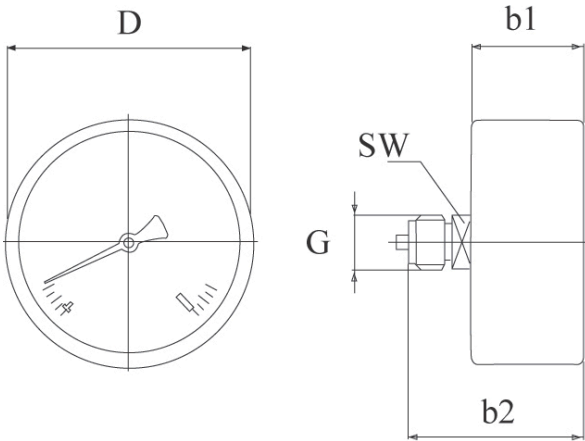

Size table:

Cabinet diameter	G	b1	b2	D	SW	Weight
		mm	mm	mm	mm	kg
R40	1/8"	26	44	40	14	0.07
R50	1/4"	27	48	50	14	0.1
R63	1/4"	27	47	63	14	0.15

Cabinet diameter	Measuring range	Pressure unit	Accuracy class	Connection type	Size process connection	Cabinet material	Window material	Material dial	Maximum overpressure	Article
mm									bar	
40	-1 / 0	bar	2.5 %	Centric	1/8" BSPP[G]	Plastic	Plastic	Plastic	0	EC0133411B4130
40	0 / 2.5	bar	2.5 %	Centric	1/4" BSPP[G]	Plastic	Plastic	Plastic	2.5	12937155
40	0 / 4	bar	2.5 %	Centric	1/8" BSPP[G]	Plastic	Plastic	Plastic	4	EC013341E2B4130
40	0 / 6	bar	2.5 %	Centric	1/8" BSPP[G]	Plastic	Plastic	Plastic	6	EC013341F2B4130
40	0 / 7	bar/psi	2.5 %	Centric	1/8" NPT	Plastic	Plastic	Plastic	7	WI013342YU-A4120
40	0 / 10	bar	2.5 %	Centric	1/8" BSPP[G]	Plastic	Plastic	Plastic	10	EC013341G2B-4130
40	0 / 10	bar	2.5 %	Centric	1/8" NPT	Stainless steel 304	Plastic	Plastic	10	13468069
50	0 / 2.5	bar/psi	2.5 %	Centric	1/4" NPT	Stainless steel 304	Plastic	Plastic	2.5	13373709
50	0 / 6	bar	2.5 %	Centric	1/4" BSPP[G]	Plastic	Plastic	Plastic	6	EC013342FID-4130
50	0 / 10	bar	2.5 %	Centric	1/4" BSPP[G]	Plastic	Plastic	Plastic	10	EC013342GID-4130
50	0 / 12	bar	2.5 %	Centric	1/8" BSPP[G]	Plastic	Plastic	Plastic	12	WI34200062
63	-1 / 0	bar	2.5 %	Centric	1/4" BSPP[G]	Plastic	Plastic	Plastic	0	EC01334312D-4130

Disclaimer: The content of this document has been composed with the utmost care. However, it is possible that certain information changes over time, becomes inaccurate or incomplete. ERIKS does not guarantee that the information provided on this document is up to date, accurate and complete; the information provided is not intended to be advice. ERIKS shall never be liable for damage resulting from the use of the information provided.

Cabinet diameter mm	Measuring range	Pressure unit	Accuracy class	Connection type	Size process connection	Cabinet material	Window material	Material dial	Maximum overpressure bar	Article
63	0 / 1	bar	2.5 %	Centric	1/4" BSPP(G)	Plastic	Plastic	Plastic	1	EC013343B2D-4130
63	0 / 1.6	bar	2.5 %	Centric	1/4" BSPP(G)	Stainless steel 304	Plastic	Plastic	1.6	WI47992794
63	0 / 2.5	bar	2.5 %	Centric	1/4" BSPP(G)	Steel	Plastic	Plastic	2.5	EC013343D2D-1130
63	0 / 4	bar	2.5 %	Centric	1/4" BSPP(G)	Plastic	Plastic	Plastic	4	EC013343E2D-4130
63	0 / 10	bar	2.5 %	Centric	1/4" BSPP(G)	Plastic	Plastic	Plastic	10	EC013343G2D-4130

Disclaimer: The content of this document has been composed with the utmost care. However, it is possible that certain information changes over time, becomes inaccurate or incomplete. ERIKS does not guarantee that the information provided on this document is up to date, accurate and complete; the information provided is not intended to be advice. ERIKS shall never be liable for damage resulting from the use of the information provided.